

# NOTICE

POTENTIAL CONDITION THAT COULD  
RESULT IN EQUIPMENT DAMAGE OR  
REDUCED SERVICE LIFE.

## SERVICE ADVISORY

**Advisory No.:** SER01420

**Date:** 4/22/2014

**Title:** H10 Crane ATB

**Product Series /Model:** H10025 & H10034 Cranes

**Summary:**

The anti-2-block system has been noted at certain angles, running full speed, with no load, that the load block can travel up and around the anti-2-block arm, which may allow 2-blocking.

**Action:**

1. Replace anti-2-block arm with new style.
2. Weld extension contact tabs to the load block.

**Procedure:**

1. Follow attached document SER01420-instructions.pdf
2. If any damage or potential problems are discovered in the visual inspection step, call Maintainer immediately for more instruction.
3. The estimated time to complete the procedures is 1 hour. Maintainer will reimburse the cost of the replacement, in the amount of \$75.00.
4. After completing the procedures, complete and return the Labor Claim Form.
5. Payment will be made upon receipt of a completed and signed Labor Claim Form, confirming that the required inspection has been successfully completed.

**Contact:** Kelly Beltman, Customer Service  
1-866-781-3259 or  
[kbeltman@maintainer.com](mailto:kbeltman@maintainer.com)



Maintainer Corporation of Iowa, Inc.  
1701 S. 2nd Ave, Box 349  
Sheldon, IA 51201  
P: 800-831-8588 F: 712-324-5600  
[www.maintainer.com](http://www.maintainer.com)

STEP 1

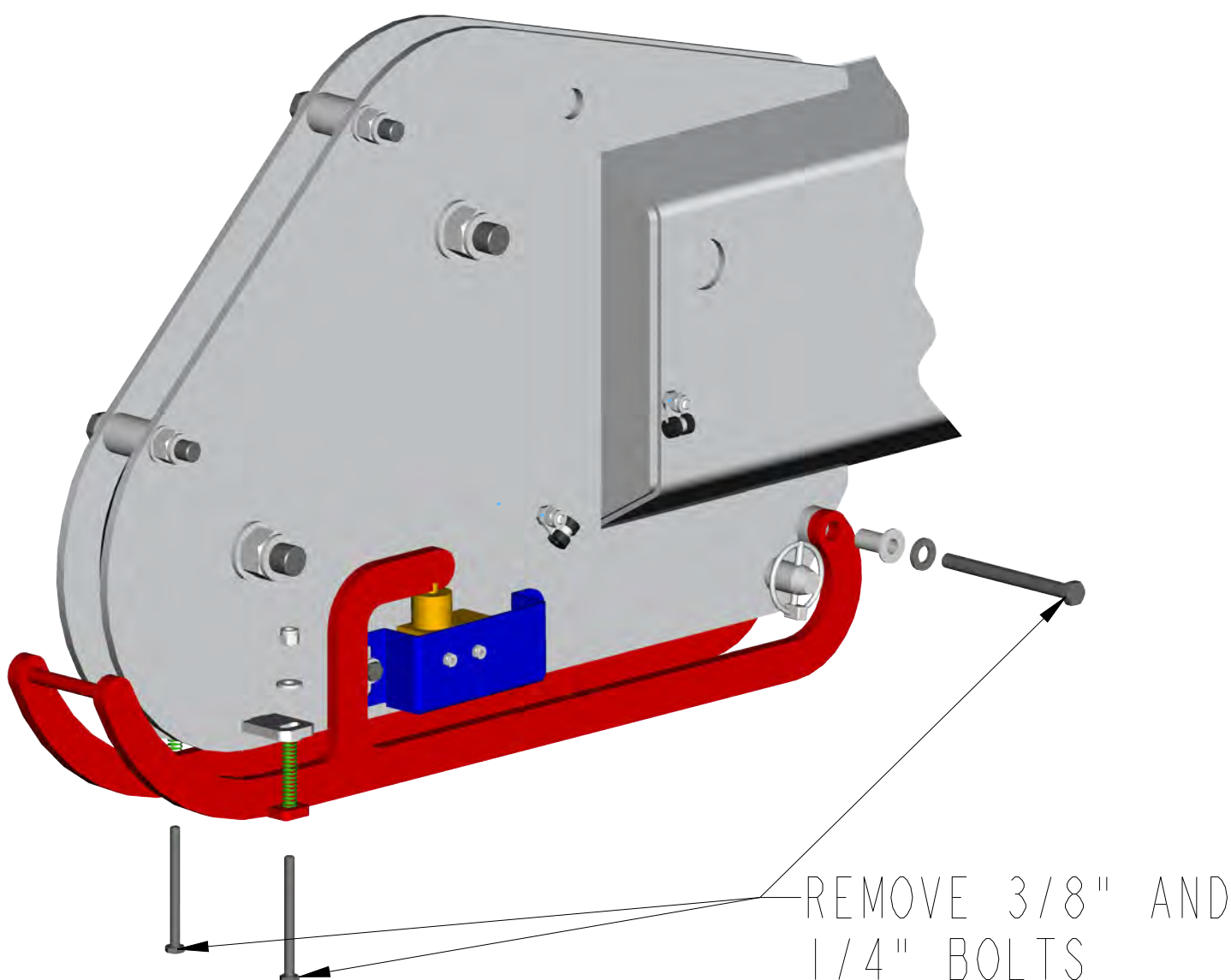

STEP 2

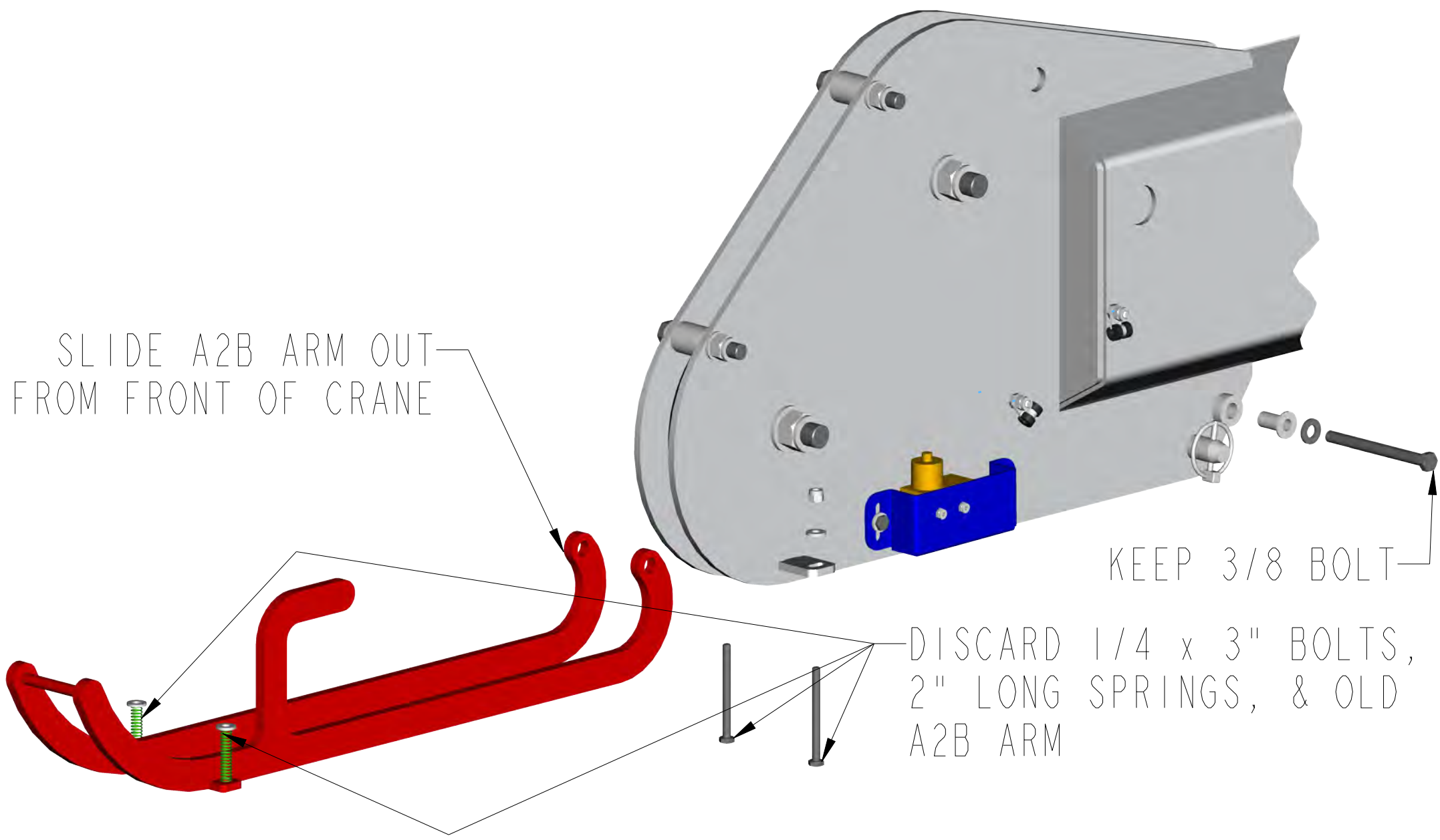

STEP 3

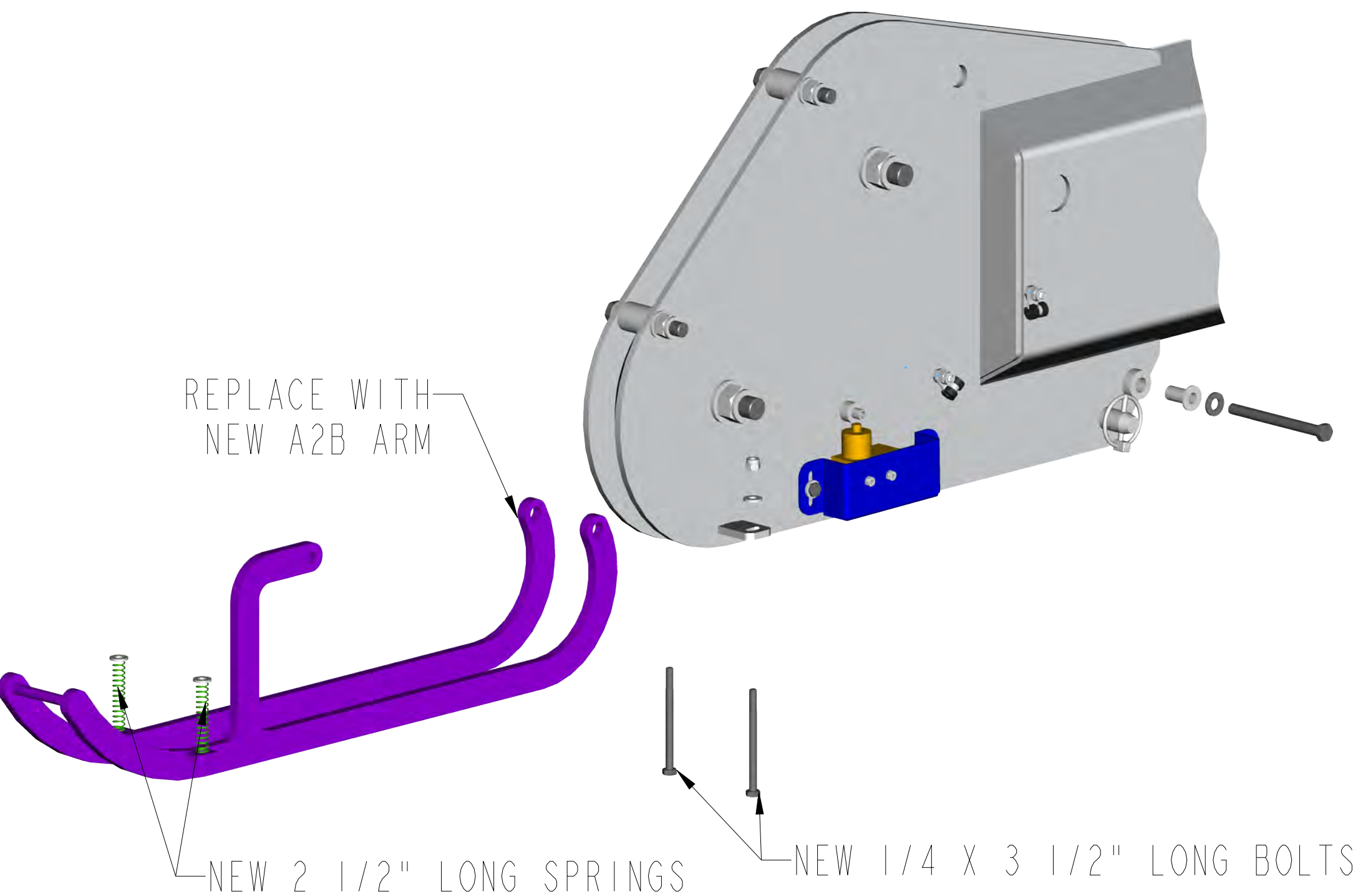

STEP 4

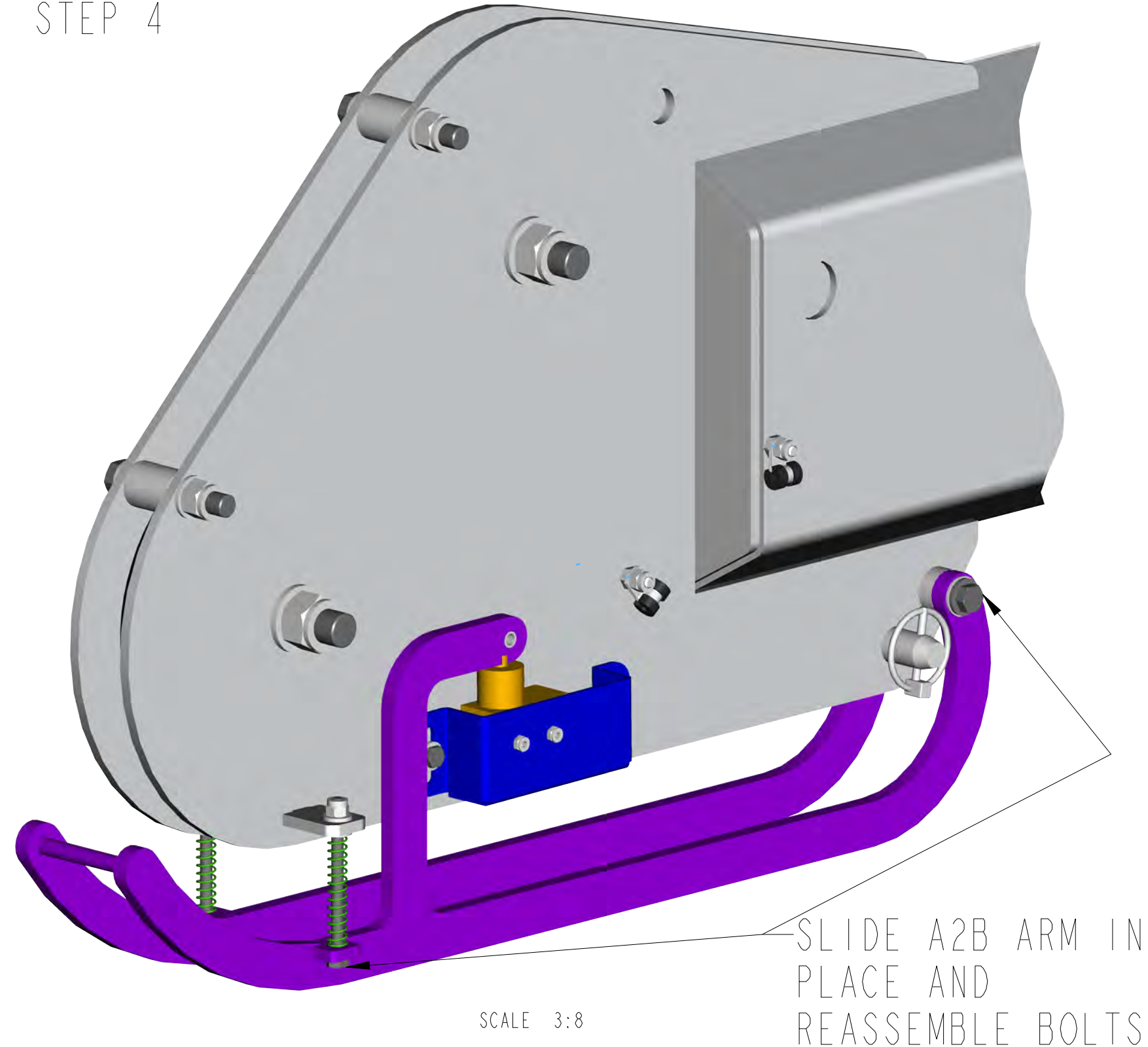



STEP 5

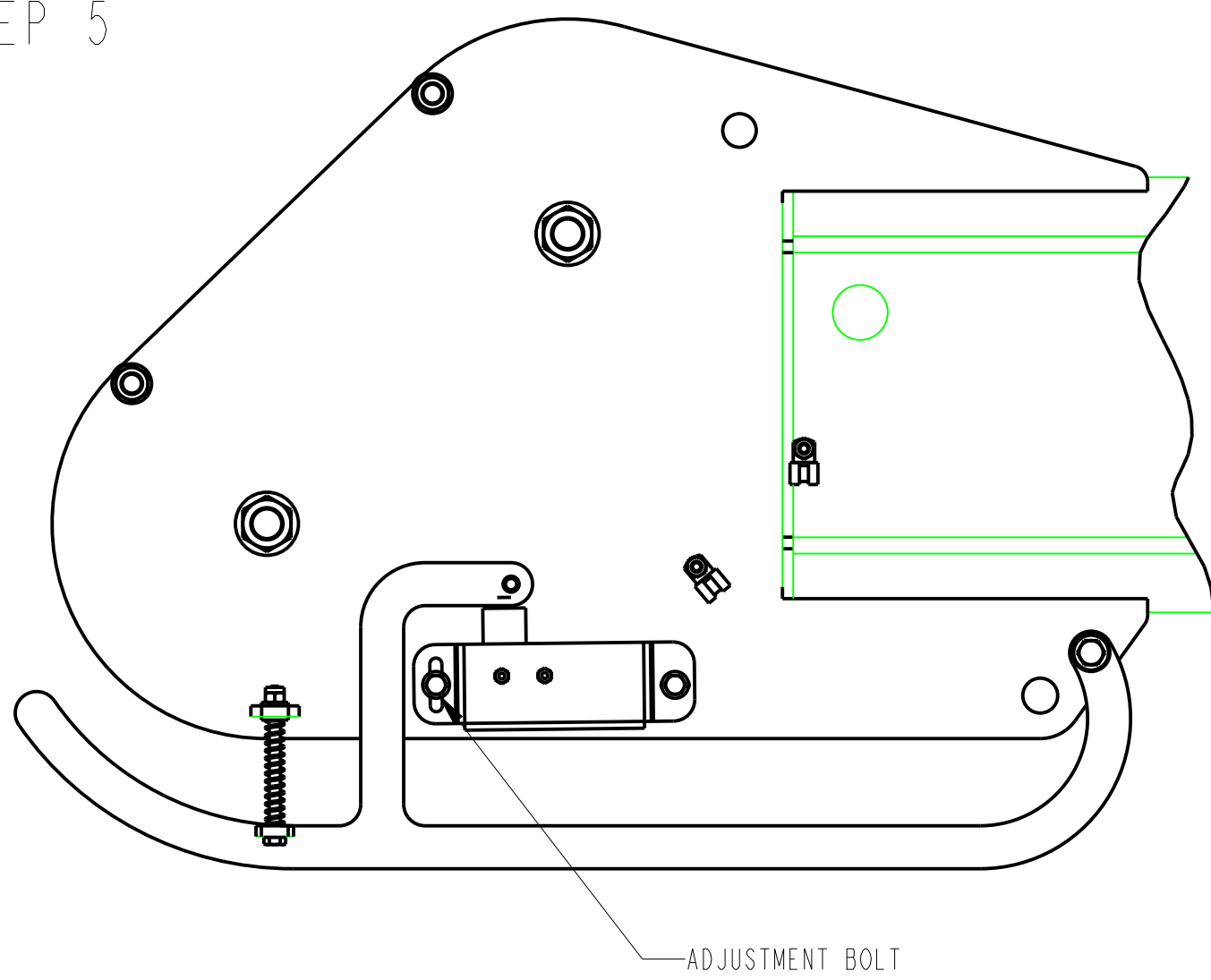

ADJUST A2B SWITCH:

- 1) ANTI-2-BLOCK SWITCH IS TO BE WIRED "NORMALLY OPEN"
- 2) ANTI-2-BLOCK SWITCH IS SET BY LOOSENING THE UPPER 1/4" BOLT AND REPOSITIONING THE SWITCH & COVER TOGETHER
- 3) MOVING THE SWITCH AND COVER AWAY FROM THE CONTACT ON THE ARM WILL MAKE THE SWITCH ACTIVATE EARLIER
- 4) THE SWITCH SHOULD TRIP AT ~3/8" OF TRAVEL AT THE FRONT END OF THE ANTI-2-BLOCK ARM

STEP 6: WELD LOAD BLOCK CONTACT EXTENDER TABS AS SHOWN. REPAINT AS NEEDED

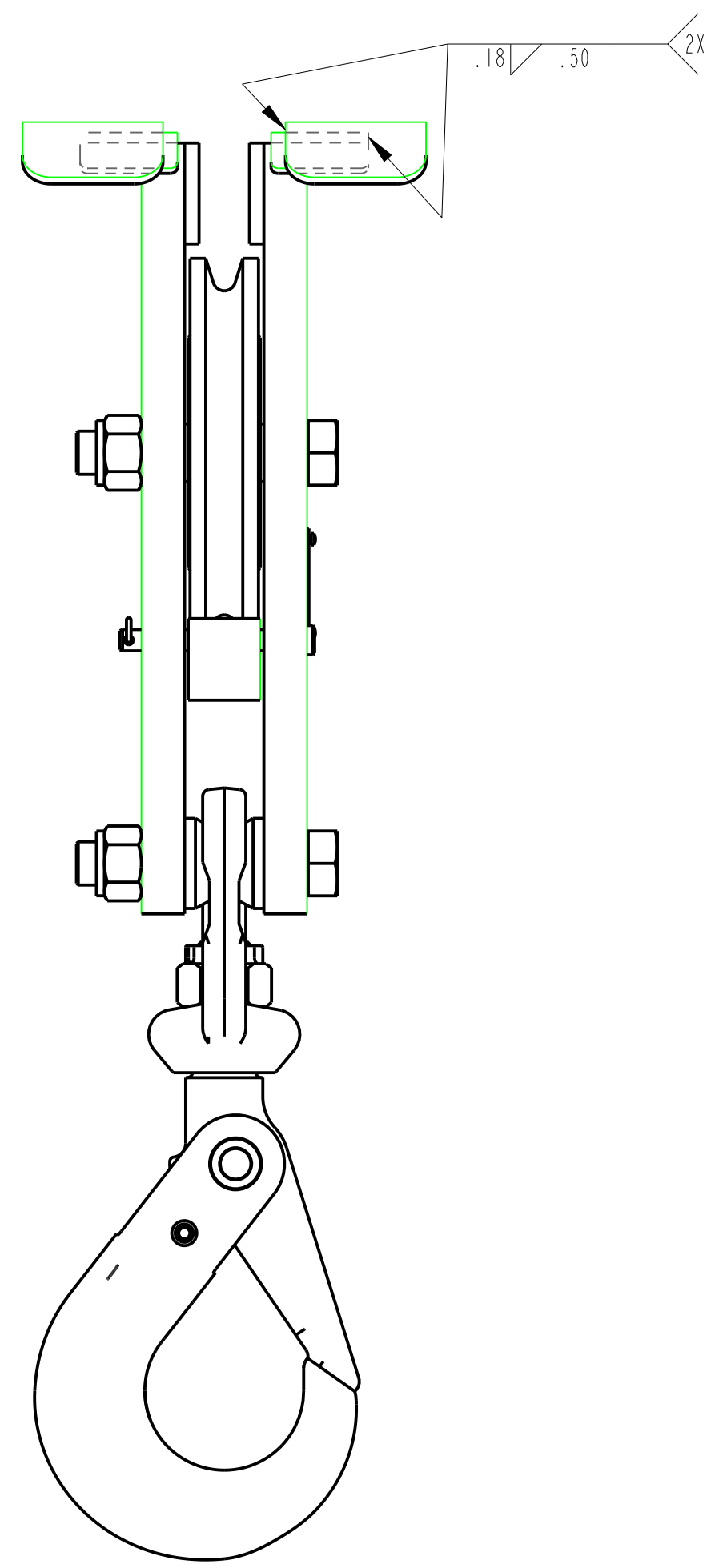
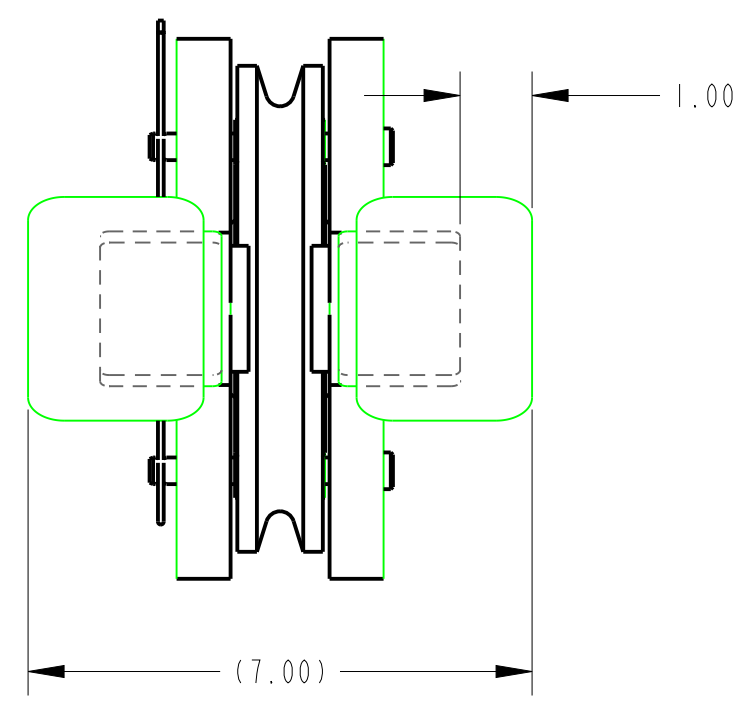

SCALE 3:8

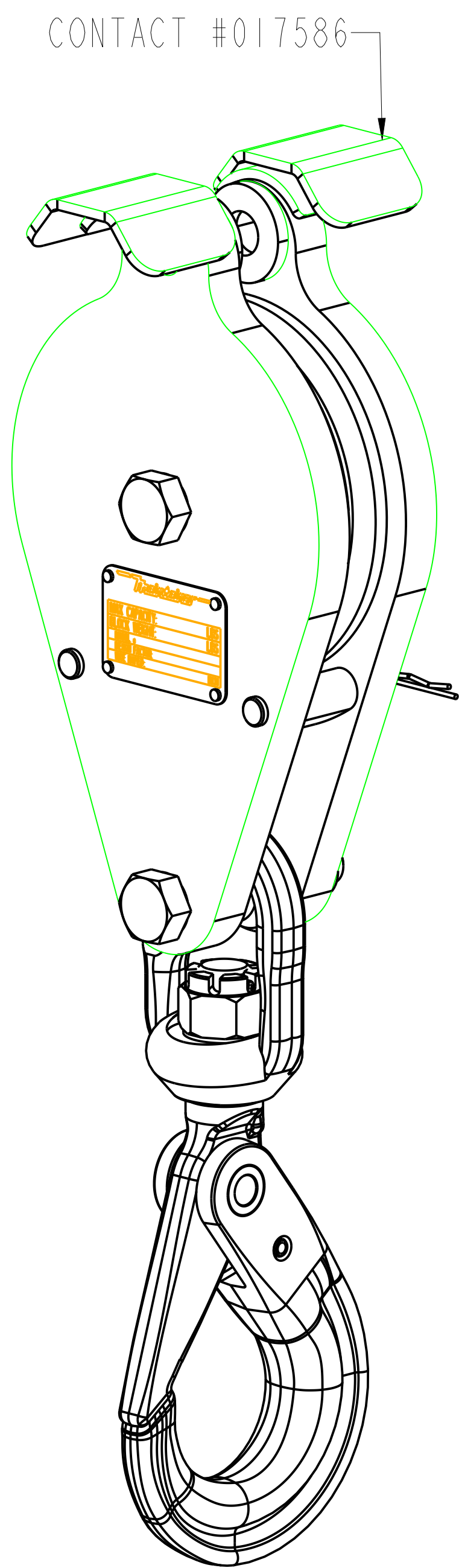

SCALE 1:2



